

Binks MODEL 107-1343 REGULATOR ASSEMBLY
Large Flow Capacity 5-125 PSIG 3/4 NPT Ports

CAUTION

Except as otherwise specified by the manufacturer, this product is specifically designed for compressed air service. Its use with any other fluid (liquid or gas) is a misapplication. For example, use with or injection of certain hazardous liquids or gases in the system (such as alcohol or liquid petroleum gas) could be harmful to the unit or result in a combustible condition or hazardous external leakage. Manufacturer's warranties are void in the event of misapplication, and manufacturer assumes no responsibility for any resulting loss.

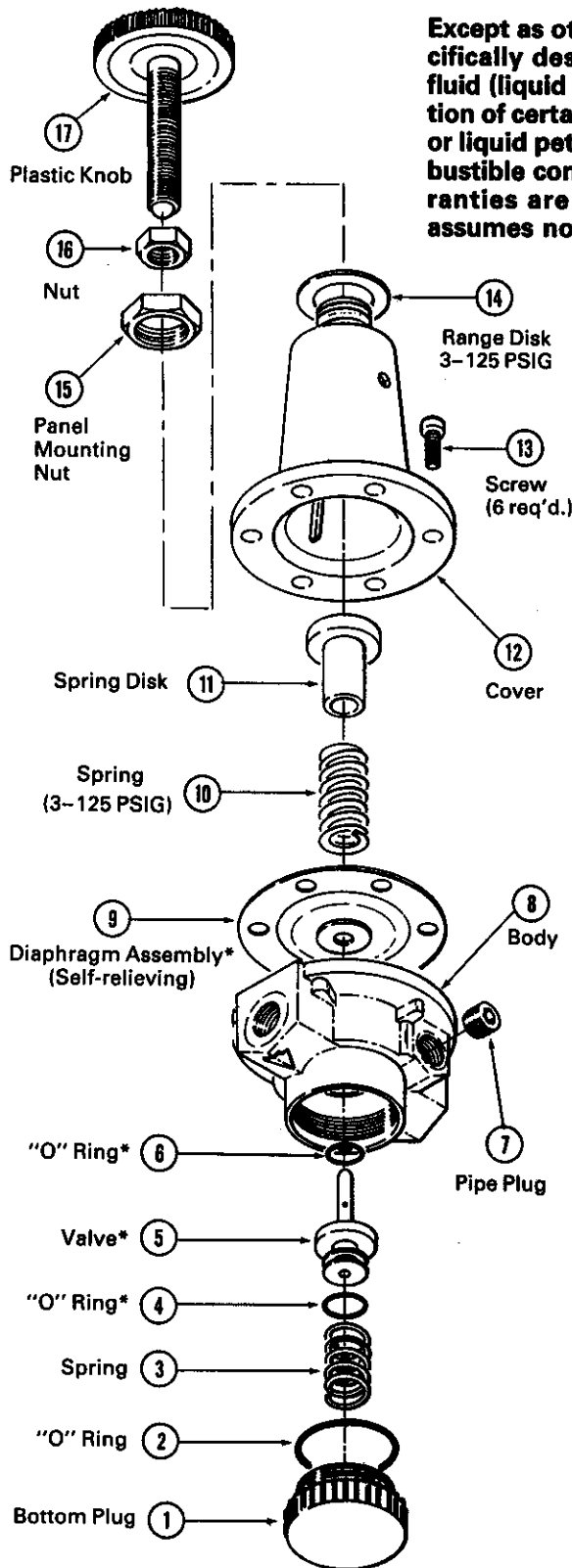

INSTALLATION

1. Maximum inlet pressure and operating temperature ratings are 300 PSIG and 200° F.
2. Install as close as possible to where regulated air is needed.
3. Install the unit with the air flowing through the body in the direction indicated by the arrow.
4. Install the same pipe size unit as the pipe line in use. Avoid using fittings, couplings, etc., that restrict the airflow, unless maximum flow is not needed.
5. Regulator may be installed so that adjusting handle (17) is in any position. Attach gauge to one 1/4-inch female gauge port and plug the other 1/4-inch female port, or use it as a regulated outlet port.
6. Turning the adjusting screw (17) "in" raises the regulated pressure and turning it "out" lowers the regulated pressure.
7. Panel mounted regulators require a 3/4-inch diameter mounting hole and are mountable on panels from 1/8-inch to 9/16-inch thick.

MAINTENANCE

1. Occasionally remove bottom plug (1) and clean plug, body (8), and valve seat (Vent air line on both sides of regulator).
2. To disassemble shut off air to regulator and vent air line on both sides of regulator. Turn adjusting screw (17) "out" to relieve compression on spring (10). (Use 7/32-inch Allen Wrench on tamper-resistant models.) Remove screws (13), cover (12), spring (10), and spring disk (11). Diaphragm assembly (9) can now be removed. By removing bottom plug (1) and spring (3), the valve (5) can be removed from the bottom of the regulator.
3. If unit will not regulate to pressure needed or if pressure becomes excessive, remove bottom plug (1), spring (3), and valve assembly (5). Clean and check "O" ring (4), valve stem and valve seat for water damage. Replace worn or damaged parts with parts from Repair Kit 44-343.
4. If unit leaks at relief port, replace worn parts with parts from Repair Kit 44-343.
5. When replacing diaphragm assembly diaphragm assembly (9) includes relieving disk seal (not shown) installed.
6. To replace "O" ring This "O" ring is above a metal washer which cannot be removed. Using a pointed probe of some kind, pull "O" ring out. Force new ring through washer hole into "O" ring cavity.

*Available in Repair Kit 44-343.
 Repair kit not furnished, please order separately.

Printed in USA 1/83



MANUFACTURING COMPANY
 9201 West Belmont Avenue, Franklin Park, Illinois 60131

Part Sheet
2315