

NEW!

**BINKS
MAG II**

MAG II HVLP Automatic Air Assist Airless Spray Guns

Use with a wide variety of coatings including UV

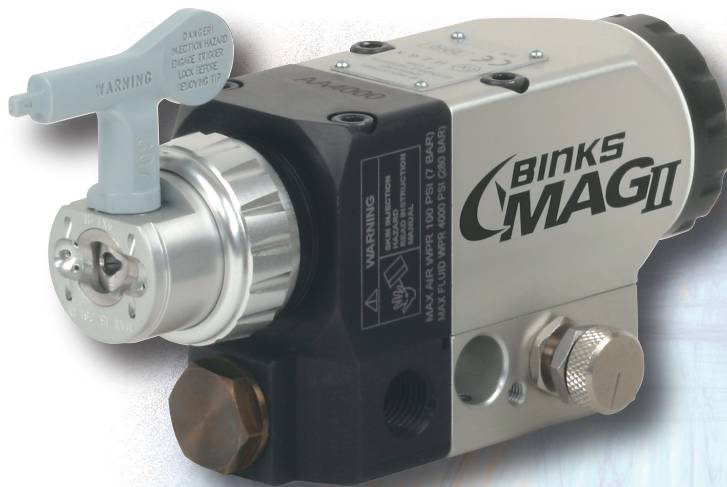

- **Full Size
Lightweight Gun**
- **Ideally Suited For
Multi-gun Finishing
Equipment**

- **Manifold Mount For
Quick Maintenance**
- **Provides High
Transfer Efficiency
HVLP Spray**



ADJUSTABLE SPRAY PATTERN • LARGE TIP SELECTION

New design provides a superior quality finish, and maximum efficiency

The unique Binks Air Assisted Airless tips and our new air caps, used on our popular handguns, are now available in the new MAG II HVLP Automatic Air Assist Airless Gun.

Three different tip options:

- **Flat Tip:** Premium tips for a uniform pattern
- **Fine Finish Tip:** Pre-orifice for best particle distribution
- **Twist Tip:** Reduces downtime caused by tip clogs

The fluid and air connections, as well as the in-line filter, are located in the manifold providing quick and easy removal of the gun for maintenance.



Time and Material Savings Benefits

- Integrated in-line fluid filter means there's no need to remove the gun body when changing filter elements
- Offered with flat tip or twist tip air caps
- Modular design for quick and easy replacement
- Superior transfer efficiency
- Reduced overspray
- Lower booth maintenance costs

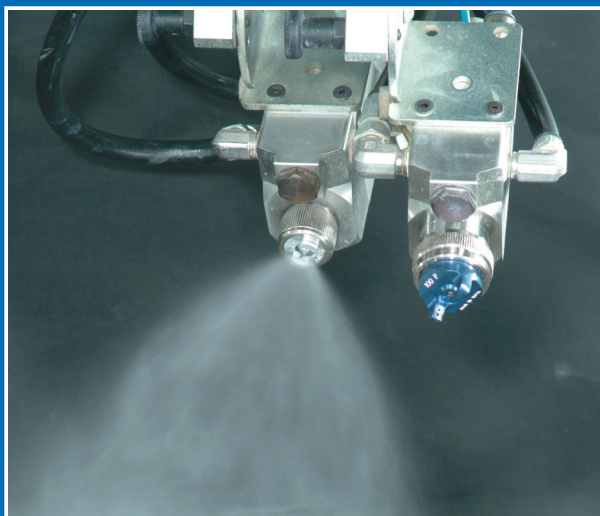

Specifications

Maximum Air Pressure:
100 psi/6.8 bar

For Flat Tip & Twist Tip HVLP compliance:
15 psi inlet pressure delivers 10 psi air cap pressure at 8 cfm air volume

Maximum Fluid Pressure: 4000 psi/275 bar

Minimum/Maximum Cylinder Actuating Pressure:
50 psi/3.4 bar (min.), 100 psi/6.8 bar (max.)

Gun Body: Aluminum

Fluid Path: Wear resistant coating

Fluid Shut Off Type: Tungsten Carbide

Fluid Inlet and Outlet Size: ¼" NPT(f) Thread

Air Inlet Size:

Atomizing Air: ¼" NPT(f) manifold body

Fan Air: ¼" NPT(f) manifold body

Cylinder Air: ⅛" NPT(f) manifold body

Gun Weight: 28.8 oz. (816g)

Gun Mounting Hole: ½" diameter (13 mm)

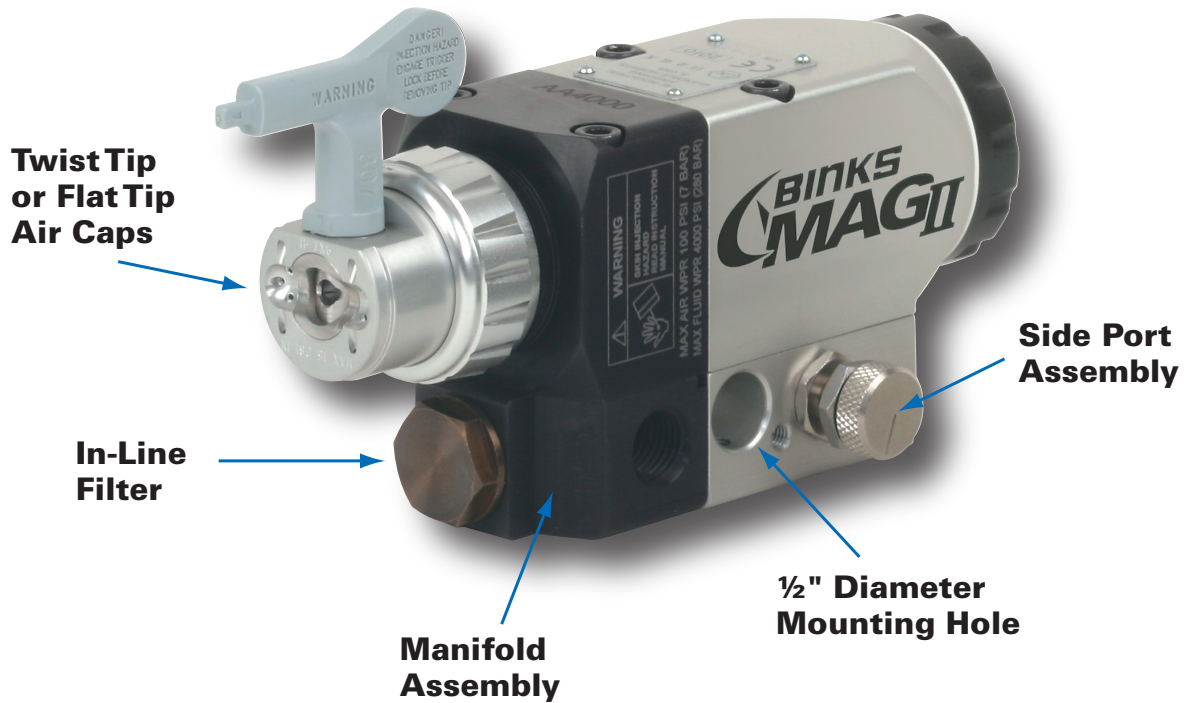

HVLP Flat / Fine Finish Tip Parts

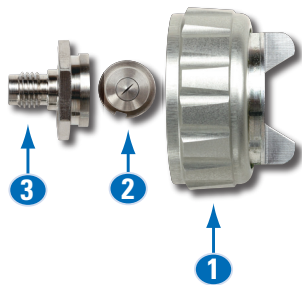

1. Flat Tip Air Cap (54-5795-K)
2. Flat Tip (114-xxxx) or Fine Finish Tip (9-xxxx-F)
3. UHMW Seat (54-5811-K); Tungsten Carbide Seat (54-5799-K)

HVLP Twist Tip Parts

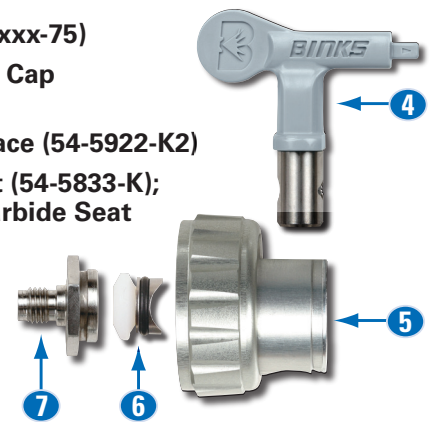

4. Twist Tip (9-xxx-75)
5. Twist Tip Air Cap (54-5924-K)
6. Twist Tip Brace (54-5922-K2)
7. UHMW Seat (54-5833-K); Tungsten Carbide Seat (54-5832-K)



How to Order MAG II Guns

| Part No. | Description |
|-----------|---------------------------------------|
| 0511-MHFO | GUN, MANIFOLD, FLAT TIP |
| 0511-OHFO | GUN, WITHOUT MANIFOLD, WITH FLAT TIP |
| 0511-MHTO | GUN, MANIFOLD, WITH TWIST TIP |
| 0511-OHTO | GUN, WITHOUT MANIFOLD, WITH TWIST TIP |

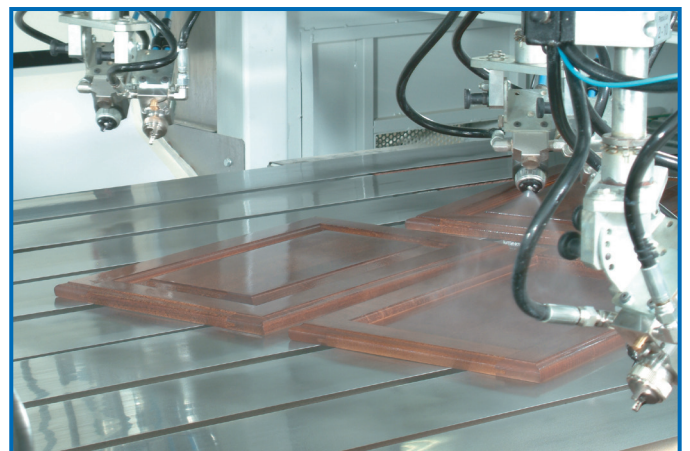



Standard Flat Tip Selection



Our premium tips for a uniform pattern.

For additional parts, refer to service bulletins 77-2949.

| Part No. | Description | Orifice | Fan Width (In.) | GPM Capacity @500 PSI Water |
|-----------|--------------|---------|-----------------|-----------------------------|
| 114-00702 | TIP ASSEMBLY | .007 | 2 | .028 |
| 114-00704 | TIP ASSEMBLY | .007 | 4 | .028 |
| 114-00706 | TIP ASSEMBLY | .007 | 6 | .028 |
| 114-00708 | TIP ASSEMBLY | .007 | 8 | .028 |
| 114-00902 | TIP ASSEMBLY | .009 | 2 | .039 |
| 114-00906 | TIP ASSEMBLY | .009 | 6 | .039 |
| 114-00908 | TIP ASSEMBLY | .009 | 8 | .039 |
| 114-00910 | TIP ASSEMBLY | .009 | 10 | .039 |
| 114-00912 | TIP ASSEMBLY | .009 | 12 | .039 |
| 114-01104 | TIP ASSEMBLY | .011 | 4 | .060 |
| 114-01106 | TIP ASSEMBLY | .011 | 6 | .060 |
| 114-01108 | TIP ASSEMBLY | .011 | 8 | .060 |
| 114-01110 | TIP ASSEMBLY | .011 | 10 | .060 |
| 114-01112 | TIP ASSEMBLY | .011 | 12 | .060 |
| 114-01114 | TIP ASSEMBLY | .011 | 14 | .060 |
| 114-01304 | TIP ASSEMBLY | .013 | 4 | .090 |
| 114-01306 | TIP ASSEMBLY | .013 | 6 | .090 |
| 114-01308 | TIP ASSEMBLY | .013 | 8 | .090 |
| 114-01310 | TIP ASSEMBLY | .013 | 10 | .090 |
| 114-01312 | TIP ASSEMBLY | .013 | 12 | .090 |

| Part No. | Description | Orifice | Fan Width (In.) | GPM Capacity @500 PSI Water |
|-----------|--------------|---------|-----------------|-----------------------------|
| 114-01314 | TIP ASSEMBLY | .013 | 14 | .090 |
| 114-01316 | TIP ASSEMBLY | .013 | 16 | .090 |
| 114-01506 | TIP ASSEMBLY | .015 | 6 | .120 |
| 114-01508 | TIP ASSEMBLY | .015 | 8 | .120 |
| 114-01510 | TIP ASSEMBLY | .015 | 10 | .120 |
| 114-01512 | TIP ASSEMBLY | .015 | 12 | .120 |
| 114-01514 | TIP ASSEMBLY | .015 | 14 | .120 |
| 114-01516 | TIP ASSEMBLY | .015 | 16 | .120 |
| 114-01518 | TIP ASSEMBLY | .015 | 18 | .120 |
| 114-01706 | TIP ASSEMBLY | .017 | 6 | .160 |
| 114-01708 | TIP ASSEMBLY | .017 | 8 | .160 |
| 114-01710 | TIP ASSEMBLY | .017 | 10 | .160 |
| 114-01712 | TIP ASSEMBLY | .017 | 12 | .160 |
| 114-01714 | TIP ASSEMBLY | .017 | 14 | .160 |
| 114-01716 | TIP ASSEMBLY | .017 | 16 | .160 |
| 114-01718 | TIP ASSEMBLY | .017 | 18 | .160 |
| 114-01906 | TIP ASSEMBLY | .019 | 6 | .190 |
| 114-01908 | TIP ASSEMBLY | .019 | 8 | .190 |
| 114-01910 | TIP ASSEMBLY | .019 | 10 | .190 |
| 114-01912 | TIP ASSEMBLY | .019 | 12 | .190 |

| Part No. | Description | Orifice | Fan Width (In.) | GPM Capacity @500 PSI Water |
|-----------|--------------|---------|-----------------|-----------------------------|
| 114-01914 | TIP ASSEMBLY | .019 | 14 | .190 |
| 114-01916 | TIP ASSEMBLY | .019 | 16 | .190 |
| 114-01918 | TIP ASSEMBLY | .019 | 18 | .190 |
| 114-02110 | TIP ASSEMBLY | .021 | 10 | .240 |
| 114-02112 | TIP ASSEMBLY | .021 | 12 | .240 |
| 114-02114 | TIP ASSEMBLY | .021 | 14 | .240 |
| 114-02116 | TIP ASSEMBLY | .021 | 16 | .240 |
| 114-02118 | TIP ASSEMBLY | .021 | 18 | .240 |
| 114-02410 | TIP ASSEMBLY | .024 | 10 | .310 |
| 114-02412 | TIP ASSEMBLY | .024 | 12 | .310 |
| 114-02414 | TIP ASSEMBLY | .024 | 14 | .310 |
| 114-02416 | TIP ASSEMBLY | .024 | 16 | .310 |
| 114-02418 | TIP ASSEMBLY | .024 | 18 | .310 |
| 114-02710 | TIP ASSEMBLY | .027 | 10 | .385 |
| 114-02712 | TIP ASSEMBLY | .027 | 12 | .385 |
| 114-02714 | TIP ASSEMBLY | .027 | 14 | .385 |
| 114-02716 | TIP ASSEMBLY | .027 | 16 | .385 |
| 114-02718 | TIP ASSEMBLY | .027 | 18 | .385 |

Fan width based on 1000 PSI with water 12" from surface. Actual results may vary, depending on material viscosity.

Fine Finish Flat Tip Selection



Includes a pre-orifice for the best particle distribution.

| Part No. | Description | Orifice | Fan Width (In.) | GPM Capacity @500 PSI Water |
|----------|-----------------|---------|-----------------|-----------------------------|
| 9-0909-F | FINE FINISH TIP | .009 | 9 | .039 |
| 9-0911-F | FINE FINISH TIP | .009 | 11 | .039 |
| 9-1109-F | FINE FINISH TIP | .011 | 9 | .060 |
| 9-1111-F | FINE FINISH TIP | .011 | 11 | .060 |
| 9-1113-F | FINE FINISH TIP | .011 | 13 | .060 |
| 9-1115-F | FINE FINISH TIP | .011 | 15 | .060 |
| 9-1309-F | FINE FINISH TIP | .013 | 9 | .090 |
| 9-1311-F | FINE FINISH TIP | .013 | 11 | .090 |
| 9-1313-F | FINE FINISH TIP | .013 | 13 | .090 |
| 9-1315-F | FINE FINISH TIP | .013 | 15 | .090 |
| 9-1509-F | FINE FINISH TIP | .015 | 9 | .120 |
| 9-1511-F | FINE FINISH TIP | .015 | 11 | .120 |
| 9-1513-F | FINE FINISH TIP | .015 | 13 | .120 |
| 9-1515-F | FINE FINISH TIP | .015 | 15 | .120 |
| 9-1517-F | FINE FINISH TIP | .015 | 17 | .120 |
| 9-1709-F | FINE FINISH TIP | .017 | 9 | .160 |
| 9-1711-F | FINE FINISH TIP | .017 | 11 | .160 |
| 9-1713-F | FINE FINISH TIP | .017 | 13 | .160 |
| 9-1715-F | FINE FINISH TIP | .017 | 15 | .160 |
| 9-1717-F | FINE FINISH TIP | .017 | 17 | .160 |

Fan width based on 1000 PSI with water 12" from surface. Actual results may vary, depending on material viscosity.

Twist Tip Selection

When converting from flat tip to twist tip, increase pattern size by 2" and use air adjustment to turn down to original size.

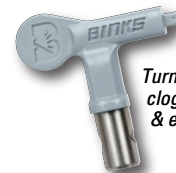

Turns to remove clogs quickly & easily.

| Part No. | Description | Orifice | Fan Width (In.) | GPM Capacity @2200 PSI |
|----------|-------------|---------|-----------------|------------------------|
| 9-307-75 | TWIST TIP | .007 | 6 | .050 |
| 9-309-75 | TWIST TIP | .009 | 6 | .090 |
| 9-409-75 | TWIST TIP | .009 | 8 | .090 |
| 9-509-75 | TWIST TIP | .009 | 10 | .090 |
| 9-311-75 | TWIST TIP | .011 | 6 | .120 |
| 9-411-75 | TWIST TIP | .011 | 8 | .120 |
| 9-511-75 | TWIST TIP | .011 | 10 | .120 |
| 9-611-75 | TWIST TIP | .011 | 12 | .120 |
| 9-313-75 | TWIST TIP | .013 | 6 | .180 |
| 9-413-75 | TWIST TIP | .013 | 8 | .180 |
| 9-513-75 | TWIST TIP | .013 | 10 | .180 |
| 9-613-75 | TWIST TIP | .013 | 12 | .180 |
| 9-713-75 | TWIST TIP | .013 | 14 | .180 |
| 9-315-75 | TWIST TIP | .015 | 6 | .240 |
| 9-415-75 | TWIST TIP | .015 | 8 | .240 |
| 9-515-75 | TWIST TIP | .015 | 10 | .240 |
| 9-615-75 | TWIST TIP | .015 | 12 | .240 |
| 9-715-75 | TWIST TIP | .015 | 14 | .240 |

Fan width based on 2200 PSI with latex paint 12" from surface. Actual results may vary, depending on material viscosity.

| Part No. | Description | Orifice | Fan Width (In.) | GPM Capacity @2200 PSI |
|----------|-------------|---------|-----------------|------------------------|
| 9-417-75 | TWIST TIP | .017 | 8 | .310 |
| 9-517-75 | TWIST TIP | .017 | 10 | .310 |
| 9-617-75 | TWIST TIP | .017 | 12 | .310 |
| 9-717-75 | TWIST TIP | .017 | 14 | .310 |
| 9-419-75 | TWIST TIP | .019 | 8 | .380 |
| 9-519-75 | TWIST TIP | .019 | 10 | .380 |
| 9-619-75 | TWIST TIP | .019 | 12 | .380 |
| 9-521-75 | TWIST TIP | .021 | 10 | .470 |
| 9-621-75 | TWIST TIP | .021 | 12 | .470 |
| 9-523-75 | TWIST TIP | .023 | 10 | .570 |
| 9-623-75 | TWIST TIP | .023 | 12 | .570 |
| 9-525-75 | TWIST TIP | .025 | 10 | .670 |
| 9-625-75 | TWIST TIP | .025 | 12 | .670 |
| 9-627-75 | TWIST TIP | .027 | 12 | .740 |
| 9-435-75 | TWIST TIP | .035 | 8 | 1.31 |

Accessories



| Description | Order Number |
|--|--------------------------------|
| New mesh filters available in 2 sizes: | 60 mesh* (kit of 5) 54-5788-K5 |
| | 100 mesh (kit of 5) 54-5789-K5 |
| Tungsten Carbide Seat Flat Tip | 54-5799-K |
| Tungsten Carbide Seat Twist Tip | 54-5832-K |

*60 mesh filters come standard with all guns.



www.binks.com

Sales and Service Through A Global Network of Industrial Distributors

North American Office
195 Internationale Blvd.
Glendale Heights, IL 60139
630-237-5000

Toll Free Customer Service
and Technical Support
800-992-4657

Toll Free Fax
888-246-5732